

# FEKA VS

## SUBMERSIBLE CENTRIFUGAL PUMP



### GENERAL DATA

#### Applications

Stainless steel submersible centrifugal pump with precision cast steel liquid vortex impeller, suitable for pumping sewer water and waste water in general containing solids up to a maximum size of 50 mm.

#### Constructional features of the pump

Pump body, seal housing cover, motor casing, cap with handle made of stainless steel. Precision cast steel impeller. Handle coated with insulating rubber. AISI 304 stainless steel motor shaft. Double mechanical seal with interposed oil chamber (non-toxic oil), made of carbon/alumina on the motor side and silicon carbide/silicon carbide on the pump side.

#### Constructional features of the motor

Dry, asynchronous, sealed and cooled by the pumped liquid. Rotor mounted on greased for-life ball bearings, oversized and selected to guarantee greater noise reduction and duration. Thermo-amperometric protection as standard for single-phase version, and the user's responsibility for the three-phase version. Constantly active capacitor on the single-phase version. Construction in accordance with the IEC 2-3 IEC 61-69 (EN 60335-2-41) standards.

Motor protection class: IP 68 - Insulation class: F

Standard voltage: 220-240V 50Hz Single-phase - 400V 50Hz Three-phase

Continual running with liquid at 35 °C and pump completely submerged. The single-phase version can be supplied with float for automatic function. Power supply cable: 10 metres of H07RN-F cable with Shuko plug for the single-phase version and 10 meters of H07RN-F cable for the three-phase version.

N.	PARTS*	MATERIALS
1	PUMP BODY	STAINLESS STEEL AISI 304
4	IMPELLER	MICROCASTING STAINLESS STEEL
7	MOTOR SHAFT	STAINLESS STEEL AISI 316
16	MECHANICAL SEAL	SILICON CARBIDE/SILICON CARBIDE CARBON/ALLUMINA
	PUMP SIDE	
	MOTOR SIDE	
36	SEAL COVER	STAINLESS STEEL AISI 304
54	MOTOR CASING	STAINLESS STEEL AISI 304
120	HANDLE	STAINLESS STEEL AISI 304 WITH INSULATING RUBBER COVER

\* In contact with the liquid

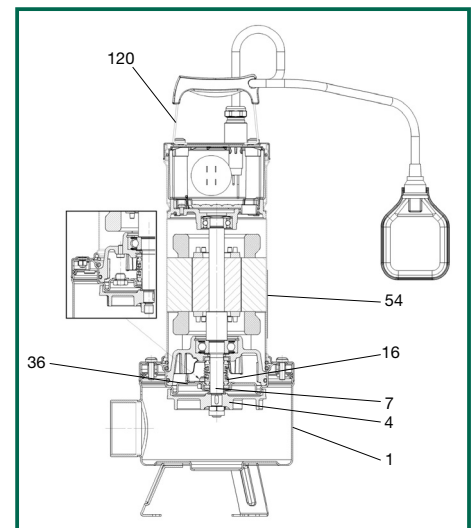

- Operating range: from 0 a 32 m<sup>3</sup>/h with head up to 14 metres.
- Pumped liquid: sewer water and waste water in general and non aggressive.
- Liquid temperature range:
  - da 0°C a +35°C for domestic use (EN 60335-2-41)
  - da 0°C a +50°C for other uses
- Maximum ambient temperature for pump running with sub-merged motor: +40°C
- Maximum immersion depth: 10 metri
- Installation: fixed or portable, vertical

The performance curves are based on the kinematic viscosity values = 1 mm<sup>2</sup>/s and density equal to 1000 kg/m<sup>3</sup>. Curve tolerance according to ISO 9906.

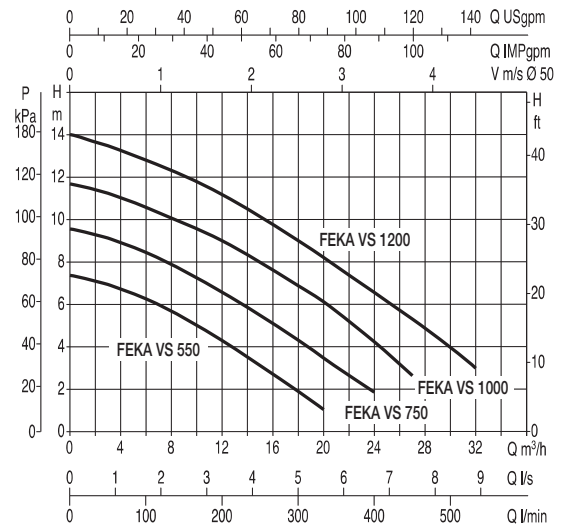
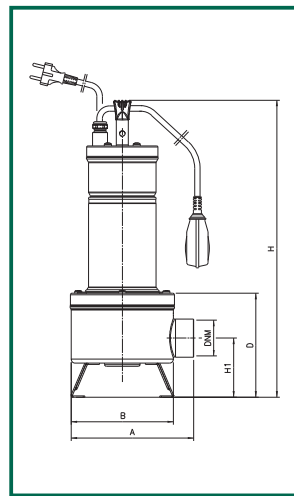
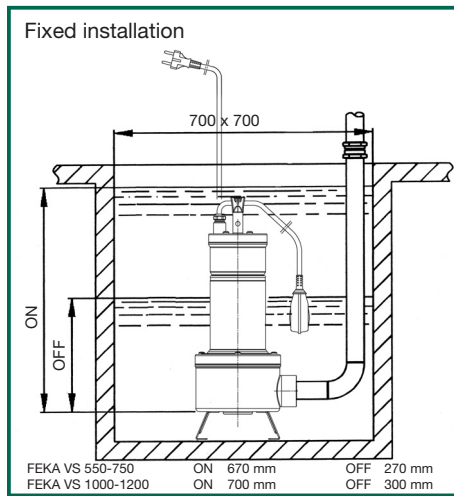

MODEL	A	B	D	H	H1	Ø DNM	PACKAGING DIM.			VOL m <sup>3</sup>	WEIGHT Kg
							L/A	L/B	H		
<b>FEKA VS 550</b>	203	170	172	492	98	2"F	240	600	240	0,034	16,3
<b>FEKA VS 750</b>	203	170	172	492	98	2"F	240	600	240	0,034	17,5
<b>FEKA VS 1000</b>	203	170	172	537	98	2"F	240	600	240	0,034	19,3
<b>FEKA VS 1200</b>	203	170	172	537	98	2"F	240	600	240	0,034	20,8

MODEL	VOLTAGE 50 HZ	ELECTRICAL DATA							HYDRAULIC DATA (N=2800 1/min)										
		P1 max W	P2 Nominal kW	HP	In A	Ist A	CAPACITOR												
							µF	VC	m <sup>3</sup> /h	0	3	6	12	18	20	24	27	32	
<b>FEKA VS 550 M-NA</b>	1x220-240 V~	927	0,55	0,75	4,2	20	20	450	H (m)	7,4	6,9	6,2	4,1	1,8	1,2	-	-	-	
<b>FEKA VS 550 M-A</b>																			
<b>FEKA VS 550 T-NA</b>																			3x400 V~
<b>FEKA VS 750 M-NA</b>	1x220-240 V~	1111	0,75	1	5,13	20	20	450		9,6	9,2	8,5	6,7	4,3	3,5	1,9	-	-	-
<b>FEKA VS 750 M-A</b>																			
<b>FEKA VS 750 T-NA</b>																			
<b>FEKA VS 1000 M-NA</b>	1x220-240 V~	1469	1	1,36	6,63	31	25	450		11,8	11,3	10,5	9	6,8	6	4,1	2,7	-	-
<b>FEKA VS 1000 M-A</b>																			
<b>FEKA VS 1000 T-NA</b>																			
<b>FEKA VS 1200 M-NA</b>	1x220-240 V~	1936	1,2	1,6	8,63	38	30	450		14	13,4	12,8	11,2	9	8,3	6,7	5,3	3	-
<b>FEKA VS 1200 M-A</b>																			
<b>FEKA VS 1200 T-NA</b>																			

# FEKA 1400 - 1800

## SUBMERSIBLE PUMPS FOR CESSPOOLS



---

## GENERAL DATA

### Applications

Submersible cast iron pump with vortex backflowing impeller for cesspools. Suitable for lifting or drainage installations for sewage from cesspools and for generally dirty water containing solids up to maximum 38 mm diameter. Also suitable for ground water, rain water, clean and dirty waste water, river or lake water.

### Constructional features of the pump

Cast iron pump body, motor casing, suction cover and impeller.

Stainless steel rotor, handle and screws.

Inspectable oil seal chamber.

Carbon/ceramic mechanical seal.

The supply vent of 2" threaded GAS is radial to facilitate assembly on the lifting devices (DSD 2).

### Constructional features of the motor

Continuous duty submersible induction motor, in a watertight casing.

Rotor mounted on oversized greased sealed-for-life ball bearings.

Thermal protection in the windings, to be connected to the control panel.

In order to operate, the pumps must be equipped with a control and protection system, supplied separately and not connected to the electropumps.

Supplied with 10 metres of neoprene rubber power cable 6x(4x1,5)+(2x0,5).

Motor protection: IP68

Insulation class: F

Manufactured according to CEI 2-3 standards.

Standard voltage:	single-phase	220-240 V/50 Hz
	three-phase	400 V/50 Hz

## TECHNICAL DATA

N.	PARTS*	MATERIALS
1	PUMP BODY	CAST IRON 200 UNI ISO 185
4	IMPELLER	CAST IRON 200 UNI ISO 185
7	MOTOR SHAFT	STAINLESS STEEL AISI 416 X12CrS13 - UNI 6900/71
10	MOTOR CASING	CAST IRON 200 UNI ISO 185
16	MECHANICAL SEAL	CARBON/CERAMIC
28	OR GASKET	VITON
29	OR GASKET	VITON
35	SUCTION COVER	CAST IRON 200 UNI ISO 185
77	PROTECTION COVER	CAST IRON 200 UNI ISO 185
120	HANDLE	STAINLESS STEEL AISI 304 X5CrNi 1810 - UNI 6900/71

\* In contact with the liquid

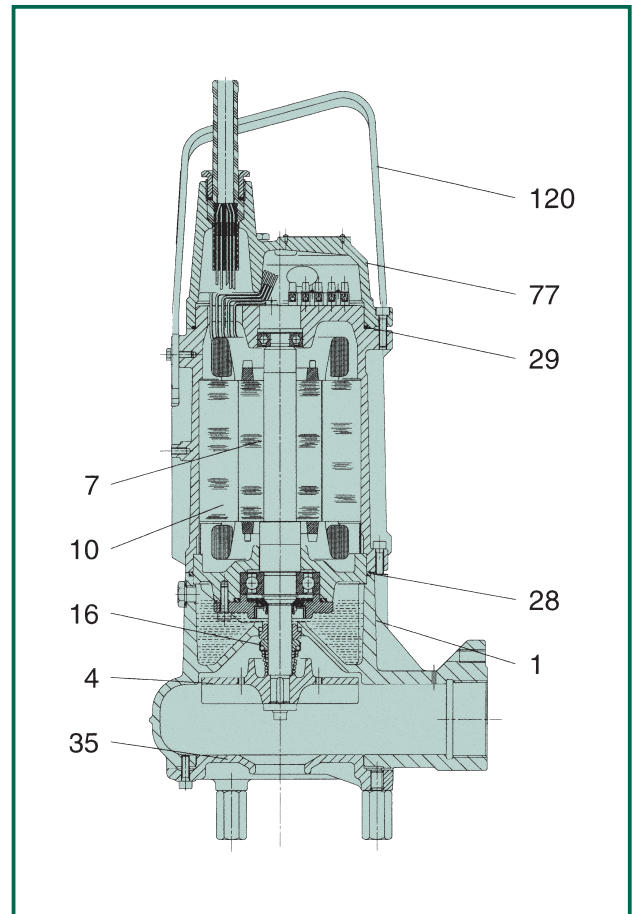

- Operating range: from 6 to 30 m<sup>3</sup>/h with head up to 14 metres for the single-phase version and 15,5 metres for the three-phase version.
- Liquid quality requirements: dirty waste water, untreated sewage containing solids, always non aggressive
- Liquid temperature range: from 0°C to +55°C
- Maximum ambient temperature for pump operation with the motor emerging: +40°C
- Free passage of solids: 38 mm
- Maximum immersion depth: 10 metres
- Installation: fixed or portable in a vertical position
- Special executions on request: other voltages and/or frequencies

The performance curves are based on the kinematic viscosity values = 1 mm<sup>2</sup>/s and density equal to 1000 kg/m<sup>3</sup>. Curve tolerance according to ISO 9906.  
Liquid temperature range: from 0°C to +55°C

## FEKA 1400 - 1800

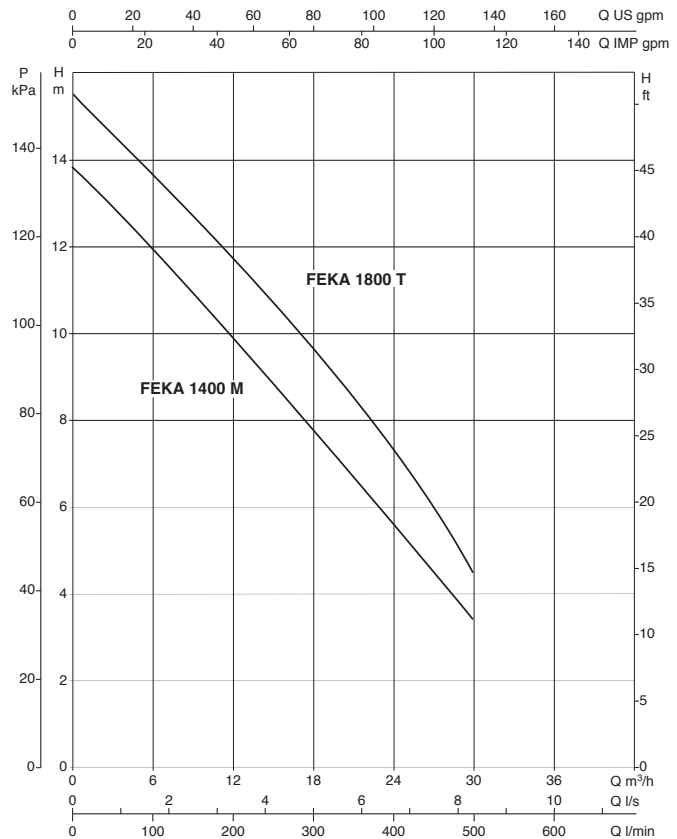
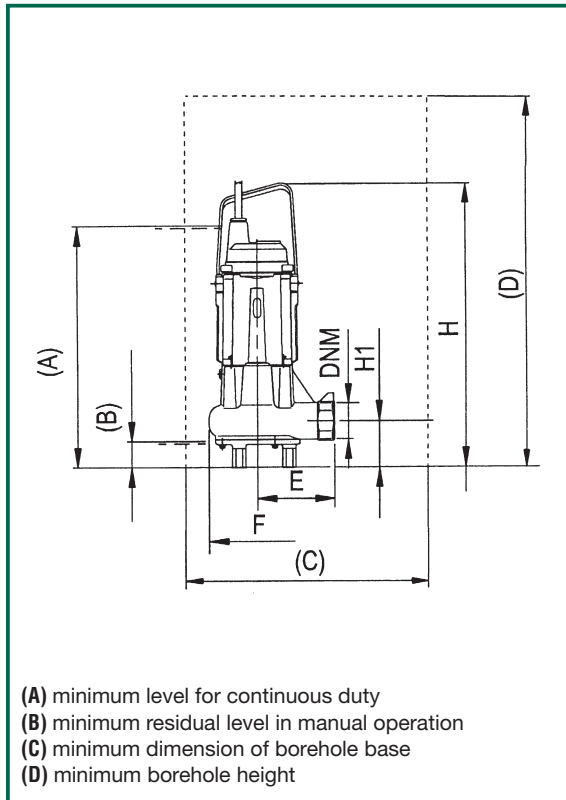

MODEL	A	B	C	D	E	F Ø	DNM	H	H1	PACKING DIMENSIONS			VOLUME m <sup>3</sup>	WEIGHT Kg
										L/A	L/B	H		
FEKA 1400 M	500	50	500x500 min	600 min	160	200	2" G	583	94	680	330	380	0,085	41,2
FEKA 1800 T	500	50	500x500 min	600 min	160	200	2" G	583	94	680	330	380	0,085	42,4

MODEL	ELECTRICAL DATA						HYDRAULIC DATA (n ≈ 2800 1/min)							
	VOLTAGE 50 Hz	P1 MAX kW	P2 NOMINAL		In A	CAPACITOR		Q m <sup>3</sup> /h l/min	0	6	12	18	24	30
			kW	HP		µF	Vc							
FEKA 1400 M	1x220-240 V ~	1,8	1,1	1,5	8,5	40	450	H (m)	13,9	12	9,9	7,8	5,7	3,4
FEKA 1800 T	3x400 V ~	1,9	1,5	2	3,7	-	-		15,5	13,7	11,8	9,7	7,3	4,5