

# DG



# saci

pumps

50Hz



## Material

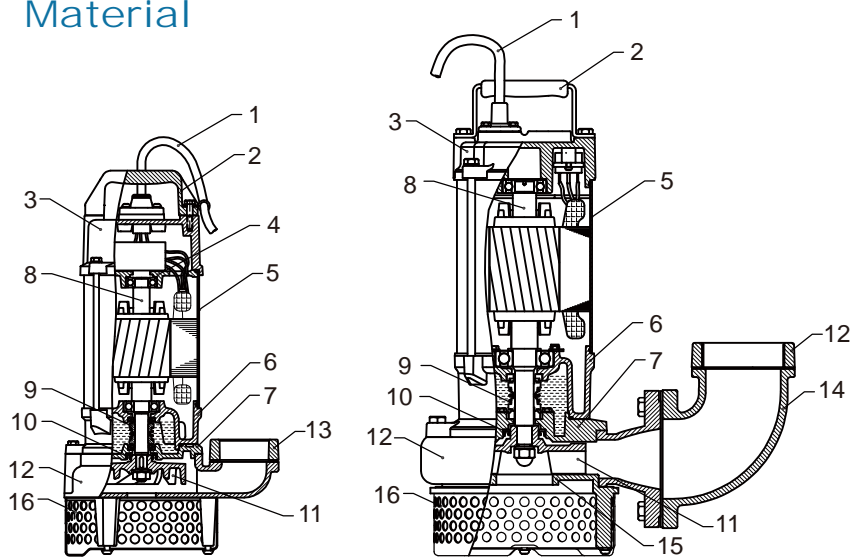

## Applications

- Basement water removal
- Waste water drainage
- Water transfer
- Sump/effluent handling
- Dewatering
- Fish pond & fountain circulation
- Factory waste water handling

## Motor

- Motor Type : 2 POLE , dry type
- Frequency : 50Hz  
Nominal Speed : 2850 rpm
- Insulation Class : F class (155°C)
- Enclosure Protection Class : IP 68
- Protection Device :  
Thermal Protector (Single phase)  
Overload Protector (Three phase)

## Pump

- Impeller : Semi Open Impeller
- Shaft Seal : Double mechanical seal + oil seal
- Bearing : Double-shielded Ball Bearing

## Operation Conditions

- Fluid Temperature: 0 to 40°C (122°F)

No.	Name	Material
1	Cable	H07RN-F
2	Handle	Nylon6+30GF (0.5~1.0HP)
		AISI 304+NBR (2.0~5.0HP)
3	Motor Cover	FC200
4	Bearing Cap	FC200
5	Motor Frame	AISI 304
6	Bearing Bracket	FC200
7	M.Seal Bracket	FC200
8	Shaft	SUS 410
9	Mechanical Seal	CA/CE,SIC/SIC
10	Oil Seal	NBR 70
11	Impeller	FC200
12	Pump Casing	FC200
13	Flange	FC200
14	Elbow	FC200
15	Suction Cover	FC200
16	Strainer	AISI 304

## Performance Curves

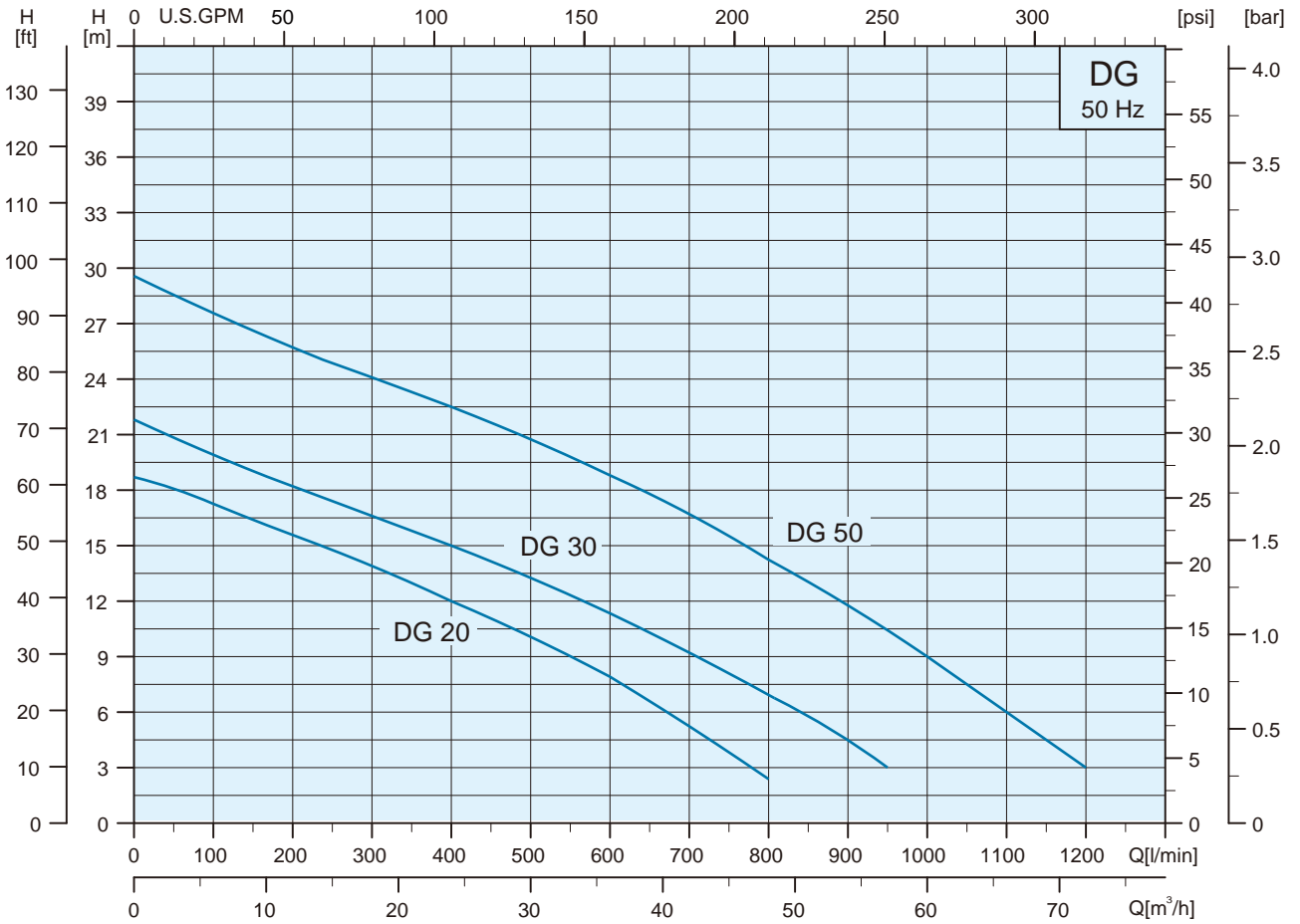

## Specifications

Model	Q = DELIVERY															
	L/min	0	100	200	300	400	500	600	700	800	900	1000	1100	1200	1300	
	m³/h	0	6	12	18	24	30	36	42	48	54	60	66	72	78	
<b>Three Phase</b>																
DG 20 T	H(m)	18.9	17.2	15.5	14.0	12.0	10.0	8.0	5.2	2.4	—	—	—	—	—	
DG 30 T		22.0	19.9	18.2	16.6	15.0	13.2	11.3	9.2	7.0	4.5	—	—	—	—	
DG 50 T		29.6	27.5	25.5	24.2	22.5	21.0	18.8	17.0	14.0	11.5	9.0	6.0	3.0	—	

## Specifications

Model	Power		Input	Nominal Current [A]		Head		Flow		Discharge inch
	HP	kW	kW	220-240V	380-415V	Rated (m)	Max. (m)	Rated (L/min)	Max. (L/min)	
<b>Three Phase</b>										
DG 20 T	2.0	1.5	2.0	6.5-6.0	3.5-3.0	10.0	18.9	500	800	2"
DG 30 T	3.0	2.2	2.9	8.7-8.0	5.0-4.5	14.0	22.0	460	950	2"
DG 50 T	5.0	3.7	4.5	14.2-13.0	8.2-7.7	20.0	29.6	540	1200	3"

## Dimensions and Weights

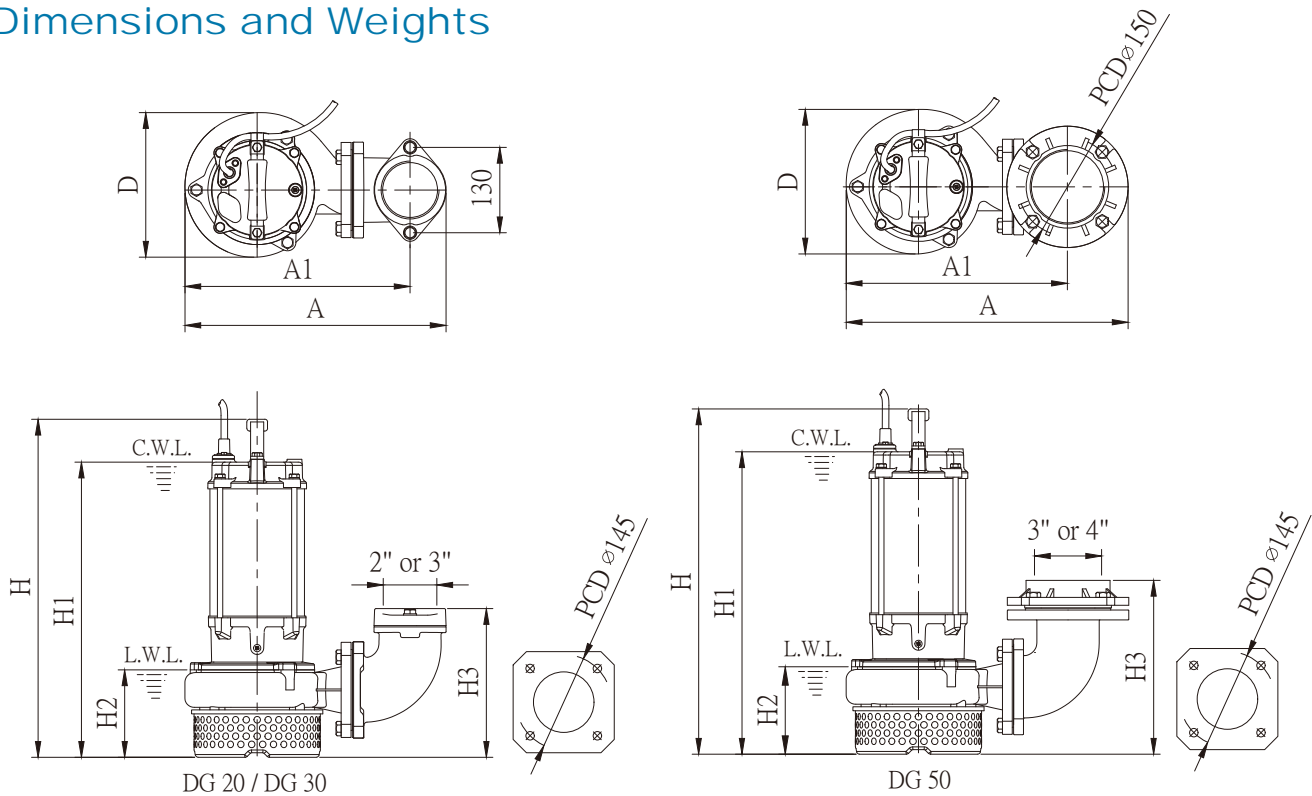

Model	Solids Passage (mm)	Dimensions (mm)							Cable		Net Weights (kg)
		A	A1	D	H	H1	H2	H3	M	H07RN-F	
<b>Three Phase</b>											
DG 20 T	10	398	343	220	506	441	133	227	10	4G1.5mm <sup>2</sup>	36.0
DG 30 T	10	398	343	220	506	441	133	227	10	4G1.5mm <sup>2</sup>	38.5
DG 50 T	10	430	337	220	526	461	133	265	10	4G2.5mm <sup>2</sup>	45.0