

VX SSF

VERTICAL MULTISTAGE CENTRIFUGAL PUMPS IN AISI 316 STAINLESS STEEL

The VX SS-F are vertical multistage, in-line, centrifugal pumps, directly connected to an electric motor. They are not self-priming. Entirely in AISI 316 stainless steel for sea water and special applications.

- HIGH HYDRAULIC EFFICIENCY
- HYDRAULIC END IN AISI 316
- MOTOR DESIGNED TO EN STANDARDS

Applications

- Water supply
- Pressure Booster Systems
- Irrigation
- High pressure washes
- Firefighting systems
- Boiler supply
- Liquid transfer

Motor

- Asynchronous electric motor with enclosed stator and external ventilation
- Main dimensions are in accordance with DIN and IEC standards
- Design: V18-up to 4,0Kw
V1- to start from 5,5Kw
- Class F insulation
- Level of protection IP 55
- Maximum environmental temperature 40 °C
- Speed of rotation 2900 rpm
- Increased bearings to last longer

Identification Name

VX SS 16 40 F T

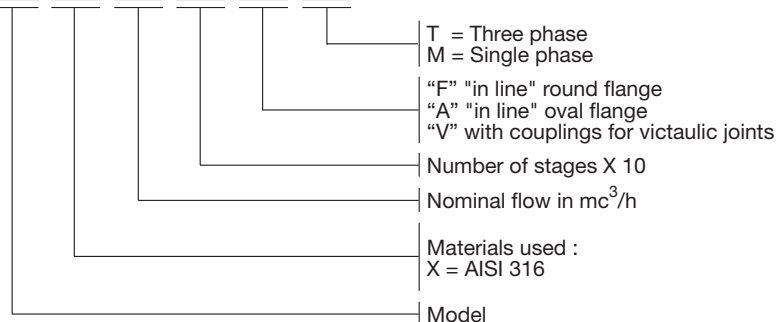

DESIGN FEATURES

Component	Material	
	VX	VX SS-F
1 Base plate	cast iron EN GJL 200	
2 Pump casing	Stainless steel X5CrNi 18-10 (AISI 304)	Stainless steel X2CrNiMo 17-12-3 (AISI 316)
3 Seal guard	Stainless steel X5CrNi 18-10 (AISI 304)	Stainless steel X2CrNiMo 17-12-3 (AISI 316)
4 Motor bracket	cast iron EN GJL 200	
5 Motor coupling	cast iron EN GJS 400	
6 Sleeve	Stainless steel X5CrNi 18-10 (AISI 304)	Stainless steel X2CrNiMo 17-12-3 (AISI 316)
7 Impeller	Stainless steel X5CrNi 18-10 (AISI 304)	Stainless steel X2CrNiMo 17-12-3 (AISI 316)
8 Diffusers	Stainless steel X5CrNi 18-10 (AISI 304)	Stainless steel X2CrNiMo 17-12-3 (AISI 316)
9 Rotating seal	silicium carbide	
10 Counterface	Graphite	
11 Shaft	Stainless steel X2CrNiMo 17-12-3 (AISI 316)	
12 Gaskets	EPDM	

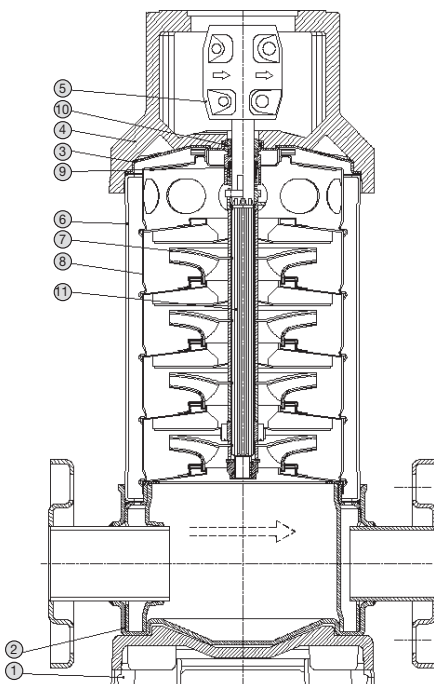
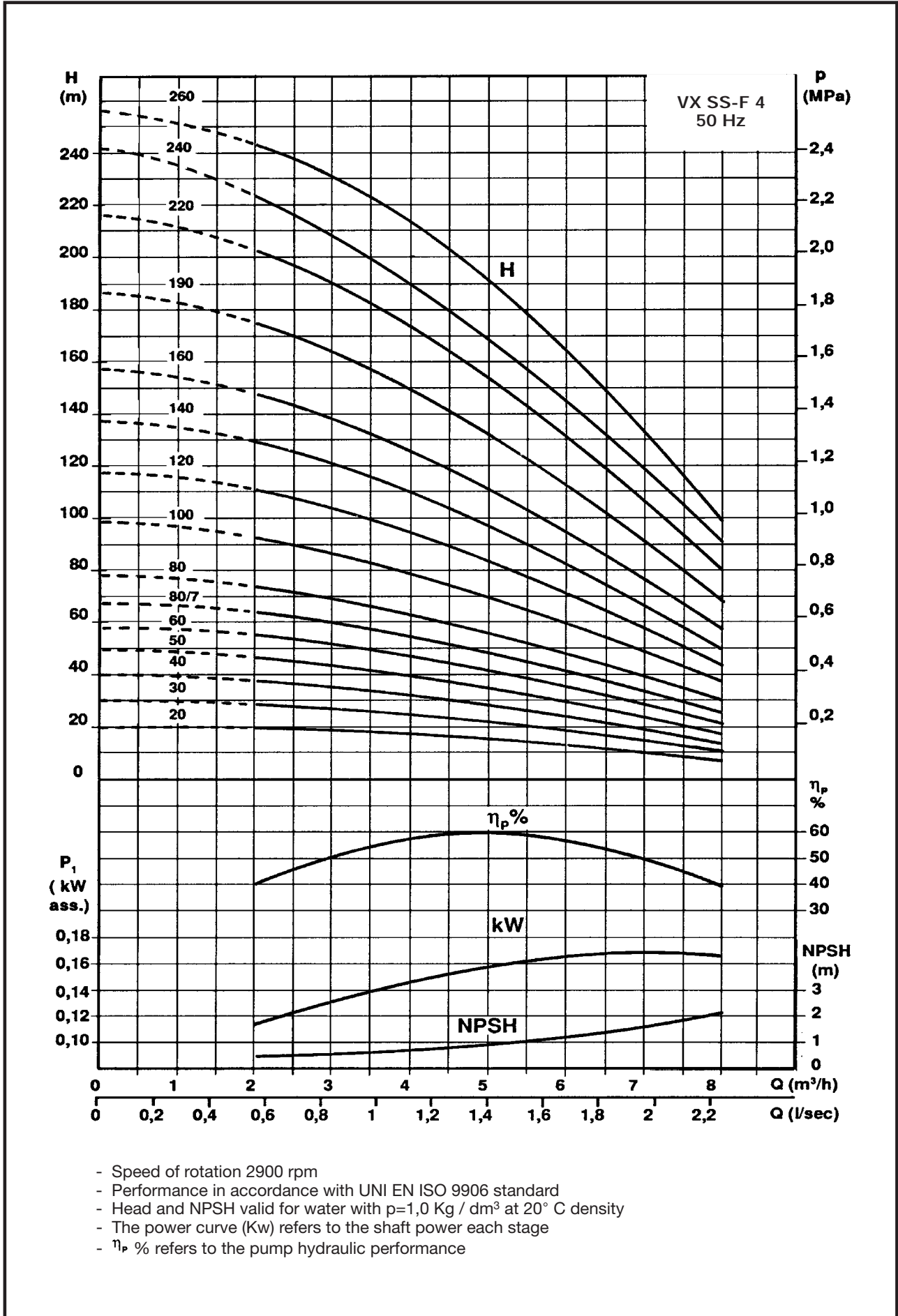

TABLE OF HYDRAULIC PERFORMANCE



PUMP PERFORMANCE

MODEL	Motor Power		VOLTAGE	Amp.	μF	Q	Discharge head in meters				
	HP	kW					L/1' m ³ /h	40	60	80	100
VX SS-F 4- 20 M VX SS-F 4- 20 T	0,50	0,37	1 ~ 230 V 3 ~ 230÷400 V	2,7 1,7 - 1,0	14	Discharge head in meters	19	17	15	13	9
VX SS-F 4- 30 M VX SS-F 4- 30 T	0,75	0,55	1 ~ 230 V 3 ~ 230÷400 V	4,0 2,5 - 1,4	16		28	25	22	19	13
VX SS-F 4- 40 M VX SS-F 4- 40 T	1,00	0,75	1 ~ 230 V 3 ~ 230÷400 V	5,2 3,3 - 1,9	25		36	33	29	25	18
VX SS-F 4- 50 M VX SS-F 4- 50 T	1,50	1,10	1 ~ 230 V 3 ~ 230÷400 V	8,0 4,3 - 2,5	35		44	42	37	31	23
VX SS-F 4- 60 M VX SS-F 4- 60 T	1,50	1,10	1 ~ 230 V 3 ~ 230÷400 V	8,0 4,3 - 2,5	35		53	50	44	38	27
VX SS-F 4- 80/7 M VX SS-F 4- 80/7 T	2,00	1,50	1 ~ 230 V 3 ~ 230÷400 V	12 5,9 - 3,4	45		61	58	51	44	32
VX SS-F 4- 80 M VX SS-F 4- 80 T	2,00	1,50	1 ~ 230 V 3 ~ 230÷400 V	12 5,9 - 3,4	45		71	67	59	50	37
VX SS-F 4-100 T	3,00	2,20	3 ~ 230÷400 V	8,3 - 4,8			90	82	72	61	46
VX SS-F 4-120 T	3,00	2,20	3 ~ 230÷400 V	8,3 - 4,8			107	99	87	73	54
VX SS-F 4-140 T	4,00	3,00	3 ~ 230÷400 V	10,9 - 6,3			124	116	102	85	63
VX SS-F 4-160 T	4,00	3,00	3 ~ 230÷400 V	10,9 - 6,3			142	132	116	97	72
VX SS-F 4-190 T VX SS-F 4-190 T	5,50	4,00	3 ~ 230÷400 V 3 ~ 400÷690 V	13,8 - 8,0			170	157	138	114	86
VX SS-F 4-220 T VX SS-F 4-220 T	5,50	4,00	3 ~ 230÷400 V 3 ~ 400÷690 V	13,8 - 8,0			196	181	160	131	101
VX SS-F 4-240 T VX SS-F 4-240 T	7,50	5,50	3 ~ 230÷400 V 3 ~ 400÷690 V	12,4 - 21,5			213	198	175	143	110
VX SS-F 4-260 T VX SS-F 4-260 T	7,50	5,50	3 ~ 230÷400 V 3 ~ 400÷690 V	12,4 - 21,5			240	221	189	156	120

VERSIONS AVAILABLE :

"F": "in line" ports with round flanges

TABLE OF SIZES AND WEIGHTS

Model	Dimensions (mm)					Net Weight (kg)
	A	B	L	D	H	
VX SS-F 4 - 20	250	215	465	158	168	26
VX SS-F 4 - 30	277	215	492	158	168	27
VX SS-F 4 - 40	308	245	553	170	203	29
VX SS-F 4 - 50	335	245	580	170	203	31
VX SS-F 4 - 60	362	245	607	170	203	32
VX SS-F 4 - 80/7	435	255	690	180	205	39
VX SS-F 4 - 80	435	255	690	180	205	39
VX SS-F 4 - 100	489	280	769	180	205	42
VX SS-F 4 - 120	543	280	823	180	205	43
VX SS-F 4 - 140	601	300	901	196	235	49
VX SS-F 4 - 160	655	300	955	196	235	49
VX SS-F 4 - 190	761	325	1086	218	256	61
VX SS-F 4 - 220	842	325	1167	218	256	63
VX SS-F 4 - 240	923	390	1313	300	350	87
VX SS-F 4 - 260	977	390	1367	300	350	89

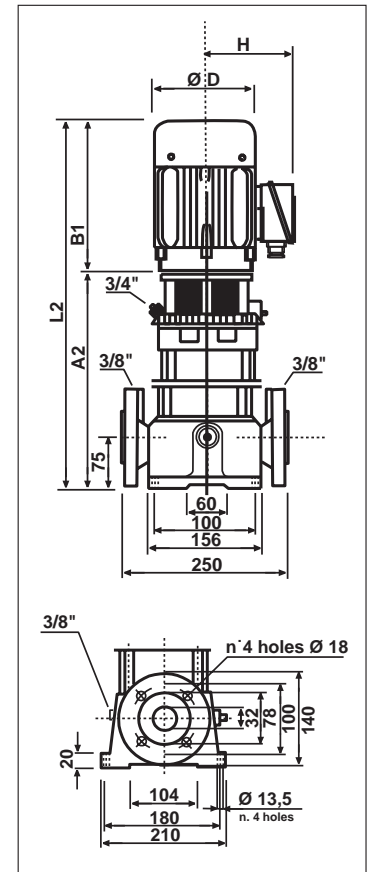
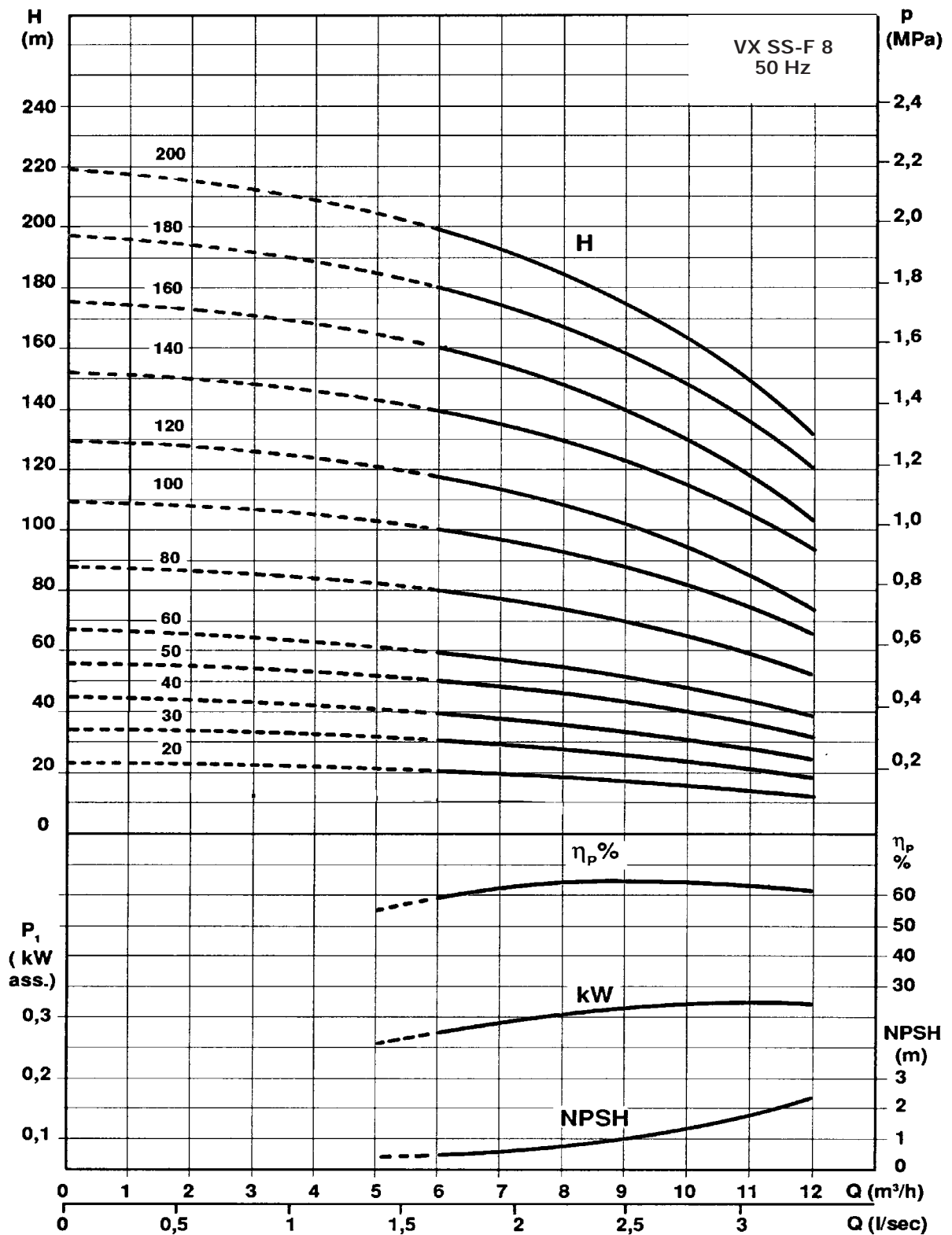

TABLE OF HYDRAULIC PERFORMANCE



- Speed of rotation 2900 rpm
- Performance in accordance with UNI EN ISO 9906 standard
- Head and NPSH valid for water with $\rho=1,0 \text{ Kg / dm}^3$ at 20° C density
- The power curve (Kw) refers to the shaft power each stage
- η_p % refers to the pump hydraulic performance

PUMP PERFORMANCE

MODEL	Motor Power		VOLTAGE	Amp.	μF	Q	Discharge head in meters				
	HP	kW					L/1' m³/h	3	6	9	10,5
VX SS-F 8 - 20 M VX SS-F 8 - 20 T	1	0,75	1 ~ 230 V 3 ~ 230 ÷ 400 V	5,2 3,3-1,9	25	Discharge head in meters	21	20	18	15	13
VX SS-F 8 - 30 M VX SS-F 8 - 30 T	1,5	1,1	1 ~ 230 V 3 ~ 230 ÷ 400 V	8 4,3-2,5	35		32	30	27	23	19
VX SS-F 8 - 40 M VX SS-F 8 - 40 T	2	1,5	1 ~ 230 V 3 ~ 230 ÷ 400 V	12 5,9-3,4	45		42	40	35	30	26
VX SS-F 8 - 50 T	3	2,2	3 ~ 230 ÷ 400 V	8,8-5,1			53	50	44	38	32
VX SS-F 8 - 60 T	3	2,2	3 ~ 230 ÷ 400 V	8,8-5,1			64	60	52	45	39
VX SS-F 8 - 80 T	4	3	3 ~ 230 ÷ 400 V	11,8-6,8			85	80	70	60	52
VX SS-F 8 - 100 T VX SS-F 8 - 100 T	5,5	4	3 ~ 230 ÷ 400 V 3 ~ 400 ÷ 690 V	16,8-9,7			106	100	88	76	65
VX SS-F 8 - 120 T VX SS-F 8 - 120 T	5,5	4	3 ~ 230 ÷ 400 V 3 ~ 400 ÷ 690 V	16,8-9,7			127	119	104	90	77
VX SS-F 8 - 140 T VX SS-F 8 - 140 T	7,5	5,5	3 ~ 230 ÷ 400 V 3 ~ 400 ÷ 690 V	21,5-12,4			149	130	122	105	92
VX SS-F 8 - 160 T VX SS-F 8 - 160 T	7,5	5,5	3 ~ 230 ÷ 400 V 3 ~ 400 ÷ 690 V	21,5-12,4			171	160	138	120	104
VX SS-F 8 - 180 T VX SS-F 8 - 180 T	10	7,5	3 ~ 230 ÷ 400 V 3 ~ 400 ÷ 690 V	28-16,4			193	181	160	135	120
VX SS-F 8 - 200 T VX SS-F 8 - 200 T	10	7,5	3 ~ 230 ÷ 400 V 3 ~ 400 ÷ 690 V	28-16,4			214	200	175	153	132

VERSIONS AVAILABLE :

"F": "in line" ports with round flanges

TABLE OF SIZES AND WEIGHTS

Model	Dimensions (mm)						Net Weight (kg)
	A	B	L	D	H	D ₃	
VX SS-F 8 - 20	245	237	422	160	131	-	33
VX SS-F 8 - 30	375	237	612	160	131	-	35
VX SS-F 8 - 40	420	265	685	185	130	-	43
VX SS-F 8 - 50	450	265	715	185	130	-	45
VX SS-F 8 - 60	480	265	745	185	130	-	46
VX SS-F 8 - 80	545	315	860	200	140	-	54
VX SS-F 8 - 100	605	335	940	200	140	-	55
VX SS-F 8 - 120	665	335	1000	200	140	-	59
VX SS-F 8 - 140	745	385	1130	260	185	300	80
VX SS-F 8 - 160	805	385	1190	260	185	300	81
VX SS-F 8 - 180	865	385	1250	260	185	300	85
VX SS-F 8 - 200	925	385	1310	260	185	300	86

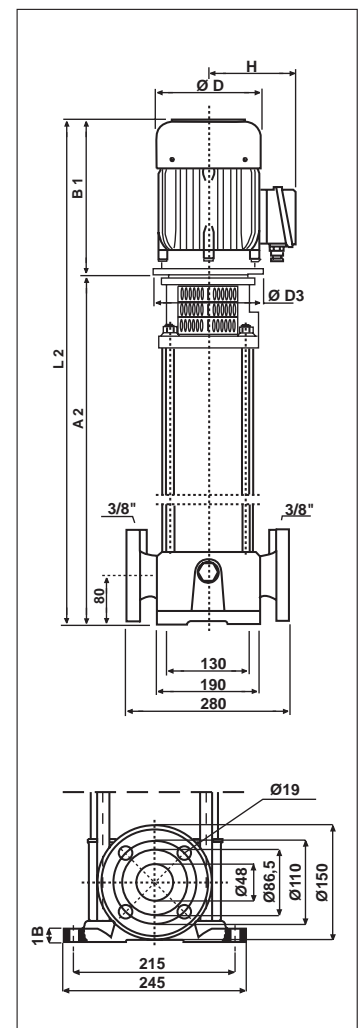
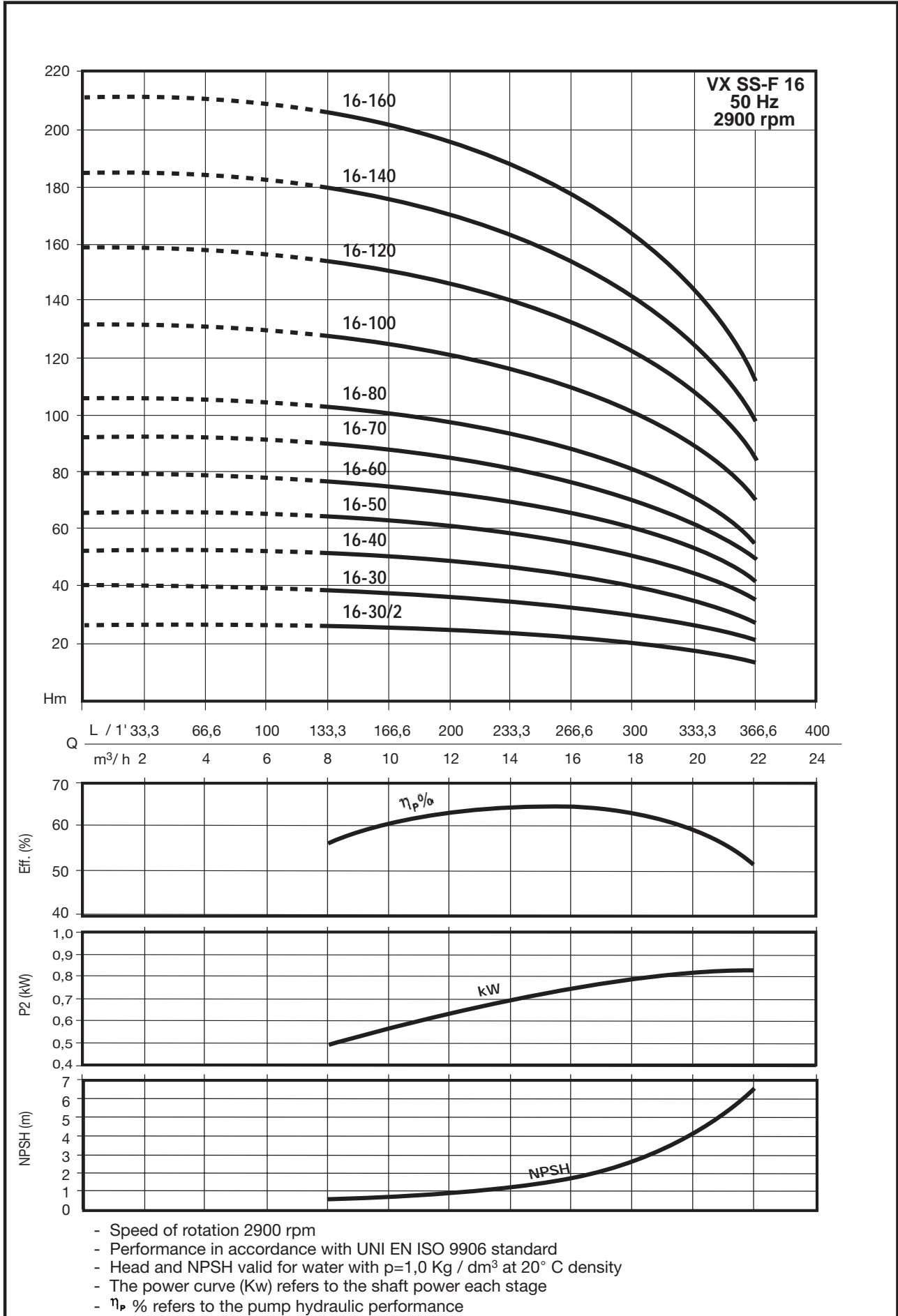

TABLE OF HYDRAULIC PERFORMANCE



PUMP PERFORMANCE

MODEL	Motor Power		VOLTAGE	Amp.	Q	Discharge head in meters				
	HP	kW				L/1'	100	200	250	300
						6	12	15	18	21
VX SS-F 16 - 30/2 T	3	2,2	3 ~ 230 ÷ 400 V	8,5-4,9	Discharge head in meters	26	25	23	20	16
VX SS-F 16 - 30 T	4	3	3 ~ 230 ÷ 400 V	11,6-6,7		39	37	34	30	24
VX SS-F 16 - 40 T	5,5	4	3 ~ 230 ÷ 400 V 3 ~ 400 ÷ 690 V	14,3-8,3 8,3-4,8		52	49	46	40	32
VX SS-F 16 - 50 T	7,5	5,5	3 ~ 230 ÷ 400 V 3 ~ 400 ÷ 690 V	19,6-11,3 11,3-8,5		65	62	57	51	40
VX SS-F 16 - 60 T	7,5	5,5	3 ~ 230 ÷ 400 V 3 ~ 400 ÷ 690 V	19,6-11,3 11,3-8,5		78	74	69	61	47
VX SS-F 16 - 70 T	10	7,5	3 ~ 230 ÷ 400 V 3 ~ 400 ÷ 690 V	24,8-14,3 14,3-8,3		91	86	80	71	55
VX SS-F 16 - 80 T	10	7,5	3 ~ 230 ÷ 400 V 3 ~ 400 ÷ 690 V	24,8-14,3 14,3-8,3		104	98	92	81	63
VX SS-F 16 - 100 T	15	11	3 ~ 230 ÷ 400 V 3 ~ 400 ÷ 690 V	36,3-21,0 21,0-12,1		130	123	115	101	79
VX SS-F 16 - 120 T	15	11	3 ~ 230 ÷ 400 V 3 ~ 400 ÷ 690 V	36,3-21,0 21,0-12,1		156	148	137	121	95
VX SS-F 16 - 140 T	20	15	3 ~ 230 ÷ 400 V 3 ~ 400 ÷ 690 V	48,4-28,0 28,0-12,6		182	172	160	142	111
VX SS-F 16 - 160 T	20	15	3 ~ 230 ÷ 400 V 3 ~ 400 ÷ 690 V	48,4-28,0 28,0-12,6		208	197	183	162	126

VERSIONS AVAILABLE :

"F": "in line" ports with round flanges

TABLE OF SIZES AND WEIGHTS

Model	Dimensions (mm)						Net Weight (kg)
	A	B	L	D	H	D _s	
VX SS-F 16 - 30/2	460	265	725	185	130	140	44
VX SS-F 16 - 30	464	315	779	200	140	250	48
VX SS-F 16 - 40	509	335	844	200	140	250	51
VX SS-F 16 - 50	575	385	960	260	185	300	74
VX SS-F 16 - 60	620	385	1005	260	185	300	76
VX SS-F 16 - 70	665	385	1050	260	185	300	82
VX SS-F 16 - 80	710	385	1095	260	185	300	84
VX SS-F 16 - 100	830	495	1325	260	185	350	128
VX SS-F 16 - 120	920	495	1425	260	185	350	132
VX SS-F 16 - 140	1010	495	1505	310	230	350	173
VX SS-F 16 - 160	1100	495	1595	310	230	350	177

